



# Ambic Cow Locator – Concrete & Rubber Matting Installation Instructions

## Tools and equipment required.

- 10mm masonry drill bit / **HSS for Rubber Matting**
- Drilling machine with hammer action
- Compressed Air
- Marker pen
- Builder's Pencil
- Hammer
- Hand broom
- Anchor setting punch
- Tape measure
- Safety glasses
- 5mm Allen key wrench

## Installation Instructions

1. Ensure that you understand and follow all safety requirements required to carry out this type of installation.
2. Position the marking template in the centre on the stall. Measure an equal distance from the bail post or cabinet to the Cow Locator on each side.
3. Measure 370mm - 400mm (depending on cow size) from the outside edge of the platform to the centre line of the marking out template.
4. Mark the position of the holes with a marker pen using the template. Remove the template, sit the locator in place, line up the mounting hole marks and mark around the outside edge of the template with the builder's pencil.

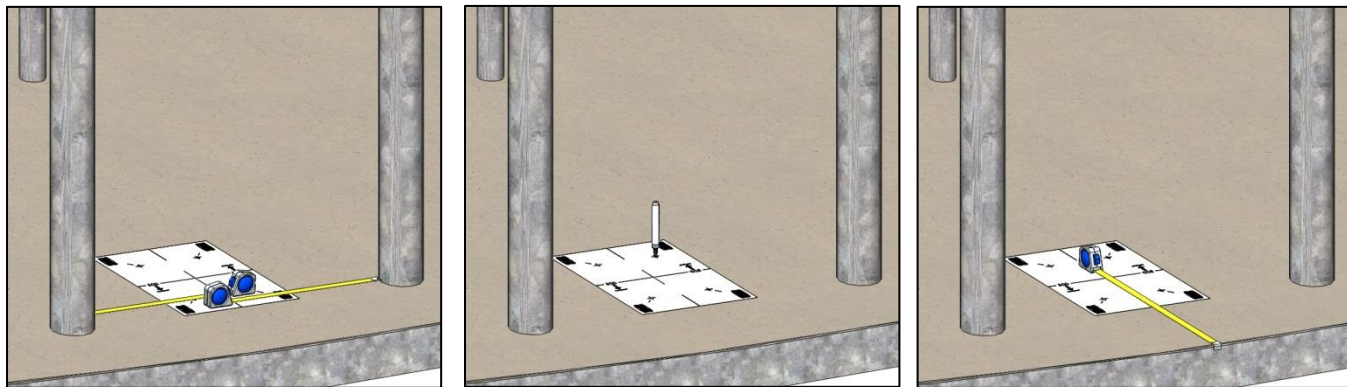

5. Remove the template and follow the appropriate instructions for Concrete (5.1) or Rubber Matting (5.2) installations.

## 5.1 Concrete Anchor Installation

The correct size of setting punch must be used to safely install drop-in anchors.



SETTING PUNCH

Drill the holes and set drop-in anchors as per the instructions below.

**NOTE:** IF YOU DRILL THE HOLES TOO DEEP – THE CAP SCREWS WILL NOT BE LONG ENOUGH.

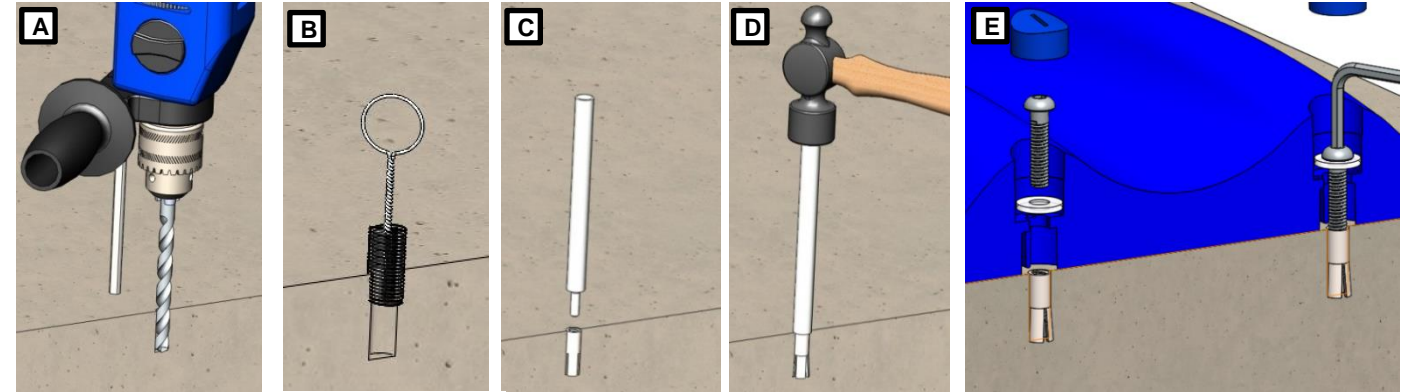

**A:** Drill correct diameter hole to correct depth. (30mm)

**B:** Clean out hole by brushing or using compressed air to remove drilling debris and/or dust.

**C:** Place anchor to drilled hole.

**D:** Expand using correct setting punch and suitable sized hammer.

**E:** Position fixture, insert bolt and tighten to recommended torque.

**NOTE:** Care must be taken not to overtighten bolt/stud if torque wrench is unavailable.

Remove all concrete dust from the area where the Cow Locator will be positioned.

## 5.2 Rubber Matting Installation

Drill the holes through the matting and locate pronged T-nuts as per the instructions below. If needed strike with hammer to ensure spikes grip into matting.

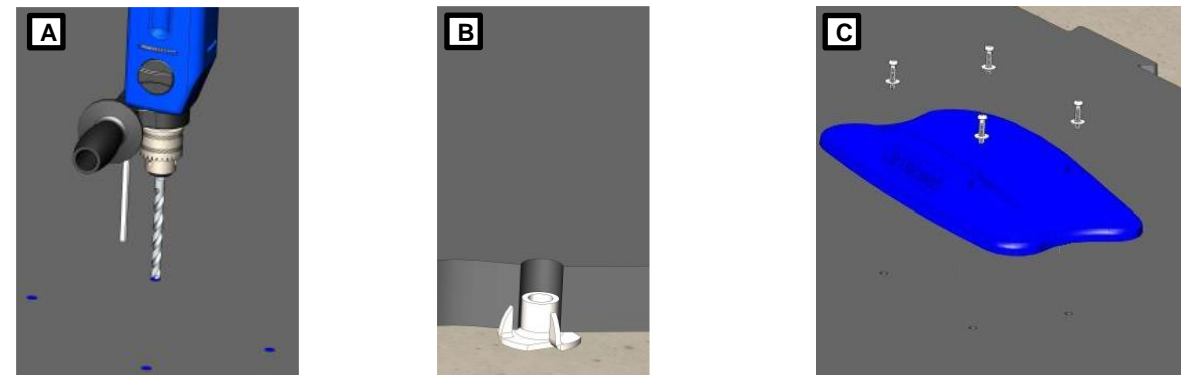

**A:** Drill correct diameter hole to correct depth.

**B:** Clean out hole. Locate and secure spiked T-nuts.

**C:** Fix with Allen head cap screws and white plastic "spacer washers".

6. Fit Locator gasket around rim of Locator and ensure secure and complete fit.
7. Place the Cow Locator in position while lining up the bolt holes.
8. Fit the Stainless Steel washers and black plastic washers to the 4 Allen head cap screws as well as the number of white plastic "spacer washers" required to ensure that the screws are secure, but can still reach the anchor thread (normally 2 or 3).
9. Locate the cap screws into the drop anchors. Tighten the cap screws evenly.  
**REMEMBER – Tight is tight, and too tight is broken.**
10. Fit the blanking plugs to each cap screw hole in the top of the Cow Locator.

