

Ambic Locator – Installation Instructions

Tools and equipment required.

Drilling machine
Marker pen
Builders Pencil
Hammer
Tape measure
Safety glasses
5mm Allen key wrench

Installation Instructions

1. Ensure that you understand and follow all safety requirements required to carry out this type of installation.
2. Position the marking template in the centre on the stall. Measure an equal distance from the bail post or cabinet to the Cow Locator on each side.
3. Measure 370mm-400mm (depending on cow size) from the outside edge of the platform to the centre line of the marking out template.
4. Mark the position of the holes with a marker pen using the template. Remove the template, sit the locator in place, line up the mounting hole marks and mark around the outside edge of the template.

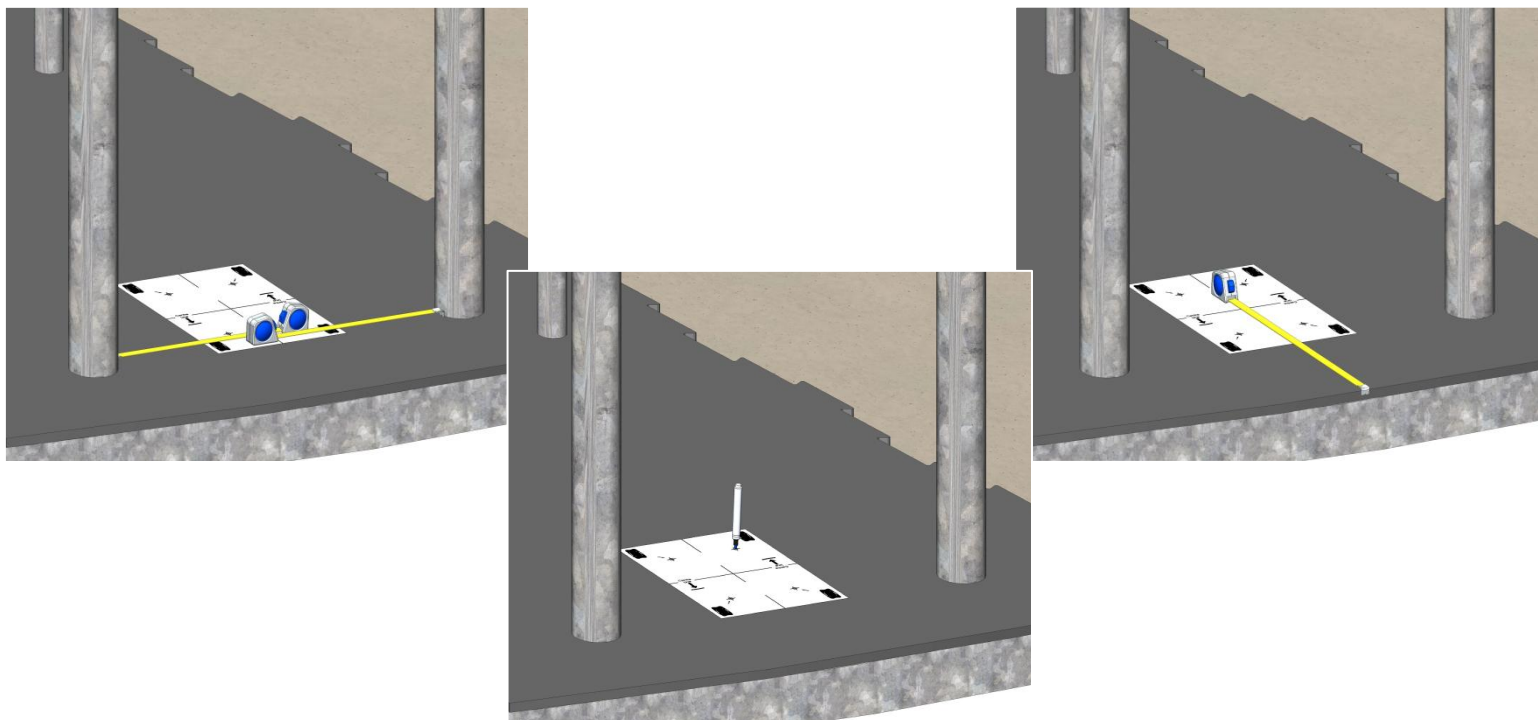

5. Remove the template, drill the holes through the matting and locate pronged T-nuts as per the instructions below. – If needed strike with hammer to ensure spikes grip into matting.

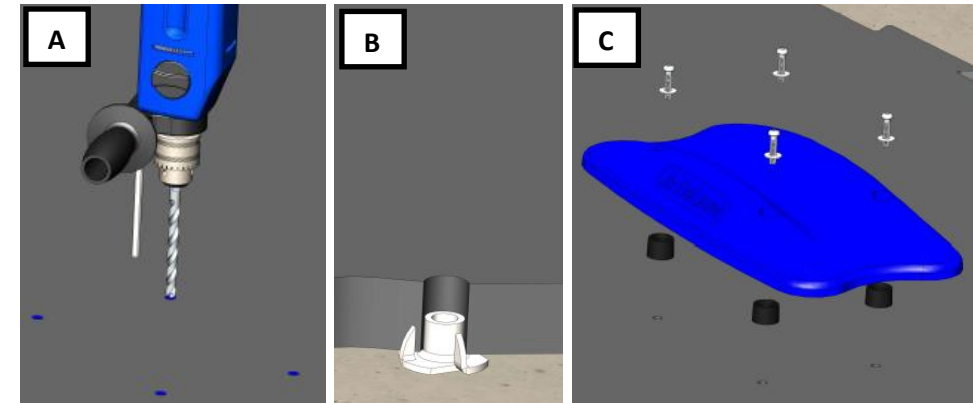

A: Drill correct diameter hole to correct depth.

B: Clean out hole. Locate and secure spiked T-nuts.

C: Add spacers, Allen head cap screws and white plastic “spacer washers”.

6. Fit the 4 black plastic spacers to the bottom of the Cow Locator.

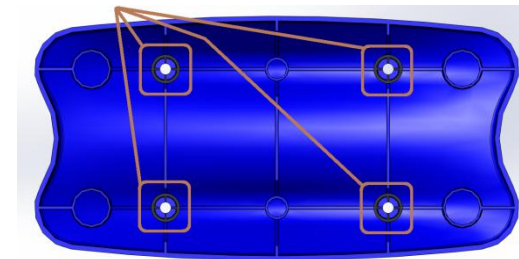

7. Fit Locator Gasket around rim of Locator and ensure secure and complete fit.
8. Place the Cow Locator in position while lining up the bolt holes.
9. Fit the Stainless steel washers to the 4 Allen head cap screws, in addition to the number of white plastic “spacer washers” required to ensure screws are secure, but can still reach the anchor thread. (Normally 2 or 3).
10. Locate the cap screws into the spiked T-nuts. Tighten the cap screws evenly.
REMEMBER – Tight is tight, and too tight is broken.
11. Fit the blanking plugs to each cap screw hole in the top of the Cow Locator.

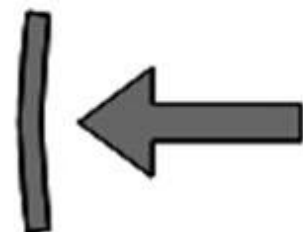
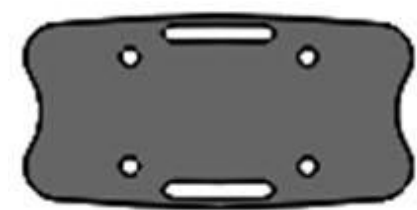

Centre
Line



Centre
Line

