

5. Make sure the connections on the peristaltic pumps are tight

If the connections are not tight, there is a risk that the connections will leak air and compromise the performance of the pumps when dispensing chemical. Ensure that no strain is put on the connections - especially when the chemical container is being changed.



6. Check the hanger assemblies

Ensure that the non-return valves and filters are installed in the correct orientation/position.

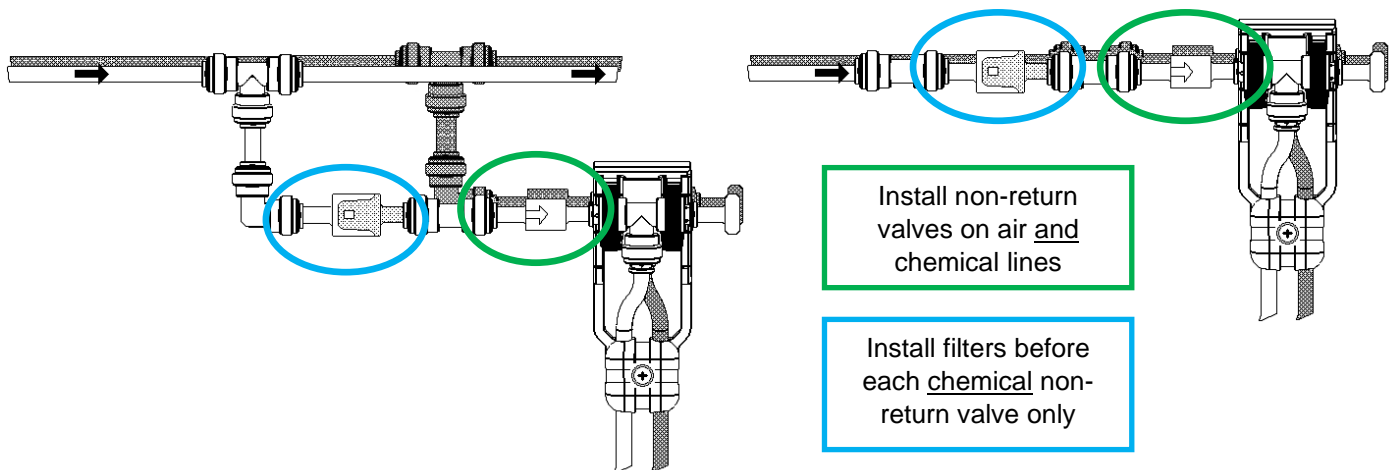

7. Adjust the air

The air regulator can be adjusted up and down to vary the 'wetness' of the foam to suit the chemical or for user preference (see *main user manual for adjusting the liquid pressure switch*).

8. Sleep Timer

To conserve power the EasiFoamer™ unit is fitted with a 'sleep function' that turns the unit off after a set period of no activity. This is set to 30 minutes by default (see *main user manual for adjusting this parameter*).

9. Make sure you are using a compatible chemical

- Do NOT use barrier dips suitable only for dipping applications;
- Use a chemical specially formulated for foaming applications;
- Use a 2 pump model for applications using 2 part chemicals such as Chlorine Dioxide.